

### Injection behind saturated oakum or open-cell backer rod using injection needles

#### Overview

After packing the annular space with saturated oakum or open-cell backer rod, inject liquid polyurethane grout behind the packing to form a more complete seal. Use a stainless steel grout injection needle connected to an airless grout pump or injection wand. SealBoss injection needles are available in various lengths.

Begin at the bottom of the pipe, at the 6 o'clock position. Insert the needle through the saturated oakum or open-cell backer rod and pump grout into the joint. Monitor grout migration by making small observation holes in the packing around the circumference of the pipe, above the active injection area.

#### Application Sequence and Illustrations

The following sequence provides a clean field workflow for annular-space grouting after the initial packing material has been installed.

1. Pack the annular space with saturated oakum or open-cell backer rod to the required depth.
2. Insert the injection needle at the 6 o'clock position and begin pumping grout behind the packing.
3. Use observation holes or vent points above the injection area to confirm grout migration around the pipe.
4. If grout does not appear at the intended observation point, relocate the needle and repeat at other positions around the pipe, such as 3 o'clock and 9 o'clock.
5. Continue the injection process until the annular space is filled and the seal is complete.

Typical injection positions are referenced like clock positions around the pipe: 6 o'clock at the bottom, 3 and 9 o'clock at the sides, and 12 o'clock at the top.

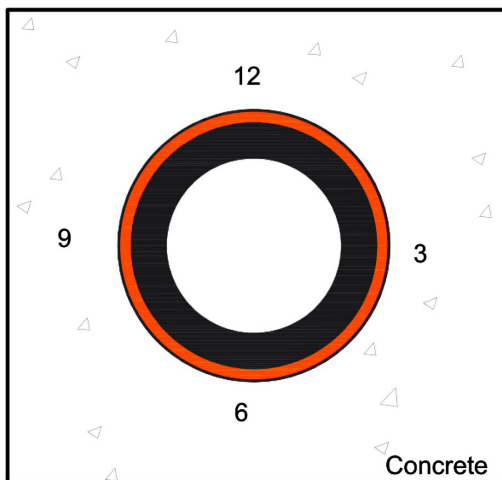

Fig. 1. Front view - pipe penetration through vertical concrete wall.

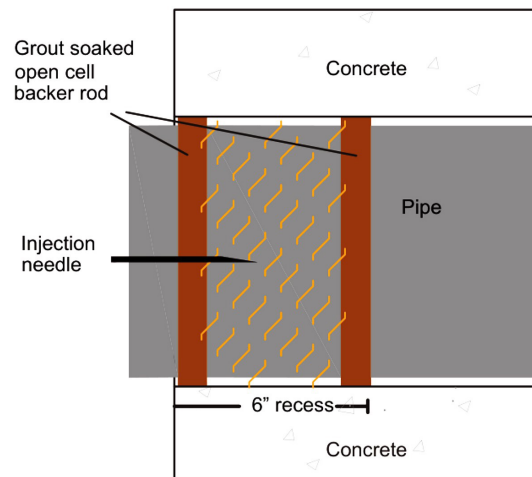

Fig. 2. Cross section - pipe penetration, annular-space grouting.

#### Injection Equipment

- Airless grout pump or drill operated pump fitted with a stainless injection needle
- Separate pump for water, if pre-wetting is required
- Moisture-resistant hose for the grout-side pump
- SealBoss approved pump cleaners & Pump Flush
- Three to four clean, empty 5-gallon buckets with lids
- Injection needles
- SealBoss polyurethane injection grout system

#### Field Notes

- Start injection at the 6 o'clock position and use upper observation points to verify material travel.
- Do not overfill the pump hopper or mix more material than can be pumped within the usable working time.
- Keep equipment dry until the grout is ready to be introduced; moisture can start the reaction prematurely.
- Use only the pump cleaner recommended for the grout system.

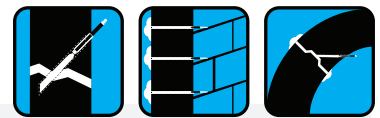

## Pump Loading and Cleanup Procedure

### Starting the Job

At the start of the workday, purge the grout pump with fresh SealBoss® R70 Pump Flush & Cleaner to remove any debris or moisture from the system.

If the pump is equipped with a suction hose, place the hose into the grout bucket. If the pump has a hopper, fill the hopper with grout. Pump grout into a waste bucket until grout flows consistently and undiluted from the applicator gun.

### Ending the Job

At the end of the workday, purge and clean the pump.

### Step One - Purge and Flush

Purge the system of the injection material into a waste bucket. If permitted under all applicable job-site regulations, the initial clearing of residual material may be performed with a solvent that is compatible with the product. Follow all solvent-use instructions and all required safety and regulatory procedures.

Please note that some solvents may damage pump seals, gaskets, and hoses. Therefore, immediately after the initial solvent purge, flush the pump with a sufficient amount of SealBoss® R70 Pump Flush & Cleaner to remove any residual product and solvent.

Dispense the liquid into a waste bucket and dispose of it legally. Do not recirculate contaminated flush material at this stage.

### Step Two - Recirculate

After most of the grout has been purged and flushed from the system, use a sufficient amount of SealBoss® R70 Pump Flush & Cleaner and recirculate it through the pump for at least five (5) minutes at a safe pressure setting.

This process helps remove remaining debris and condition the gaskets, hose interiors, and related pump components, helping to prolong the service life of the pumping equipment. A residual amount of clean SealBoss® R70 Pump Flush & Cleaner may remain in the system as a lubricant.

Fresh pump cleaner may remain in the system overnight only. Always purge the pump with fresh pump cleaner before loading grout into the pump.



**Limited Warranty Policy and Disclaimer for Products Supplied and/or Distributed by SealBoss Corp.:** SealBoss Corp. Products are for Professional Use. All recommendations, statements and technical data herein are based on tests we believe to be reliable and correct, but accuracy and completeness of said tests are not guaranteed and are not to be construed as a warranty either expressed or implied. User shall rely on his or her own information and tests to determine suitability of the product for the intended use and user assumes all risk and liability resulting from his or her use of the product. Nothing contained in any supplied materials relieves the user of the obligation to read and follow the warnings and instruction for each product as set forth in the current Technical Data Sheet, product label and Safety Data Sheet prior to product use. SealBoss Corp. warrants supplied / distributed products to be free of manufacturing defects. Seller's and manufacturer's sole responsibility shall be to replace that portion of the product of the manufacturer which proves to be defective. There are no other warranties by SealBoss Corp. of any nature whatsoever expressed or implied, including any warranty of merchantability or fitness for a particular purpose in connection with this product. SealBoss Corp. shall not be liable for damages of any sort, including remote or consequential damages resulting from any claimed breach of any warranty whether expressed or implied. SealBoss Corp. shall not be responsible for use of this product in a manner to infringe on any patent or any other intellectual property rights held by others. In addition, no warranty or guarantee is being issued with respect to appearance, color, fading, chalking, staining, shrinkage, peeling, UV damage, excessive temperature exposure, normal wear and tear or improper application by the applicator. Damage caused by abuse, neglect and lack of proper maintenance, acts of nature and / or physical movement of the substrate or structural defects are also excluded from the limited warranty. SealBoss Corp. reserves the right to conduct performance tests on any material claimed to be defective prior to any repairs by owner, general contractor, or applicator. Neither seller nor manufacturer shall be liable to the buyer or any third person for any injury, loss or damage directly or indirectly resulting from use of or inability to use the product. Recommendations and statements other than those contained in a written agreement signed by an officer of the manufacturer shall not be binding upon the manufacturer or seller. SealBoss Corp. reserves the right to change the properties of products without notice.

Revised 202604

